

B16FC-RGA

PN16

DN50~600



SPECIFICATION

RISING STEM · OUTSIDE SCREW AND YOKE

BS 5150 · FLANGED TO BS 4504 PN16

PRESSURE / TEMPERATURE RATINGS

	DN50~300	DN350~600
Working Pressure	16 bar	10 bar
Testing Pressure	Shell : 24 bar Seat : 17.6 bar	Shell : 15 bar Seat : 11 bar
Working Temperature	-10 °C to 120 °C	
Suitable Media	Water, Oil & Gas	

* 16 bar pressure rating is available for DN350~600. The body material shall be Ductile Iron.

MATERIALS

Part	Material	BS
Body	Cast Iron	1452 Gr. 220
Bonnet	Cast Iron	1452 Gr. 220
Disc	Cast Iron	1452 Gr. 220
Seat Ring	Gunmetal	1400 LG2
Stem	Brass Stainless Steel	2874 CZ124 970 420S37
Packing	Graphite	Non-Asbestos
Handwheel	Cast Iron	1452 Gr.220

DIMENSIONS

Size mm	L mm	H (Open) mm	D mm
50	178	405	190
65	191	415	190
80	203	486	190
100	229	632	300
125	254	710	300
150	267	842	350
200	292	1100	350
250	330	1228	400
300	356	1373	450
350	381	1595	508
400	406	1900	558
450	432	2210	610
500	457	2490	610
600	508	2960	762

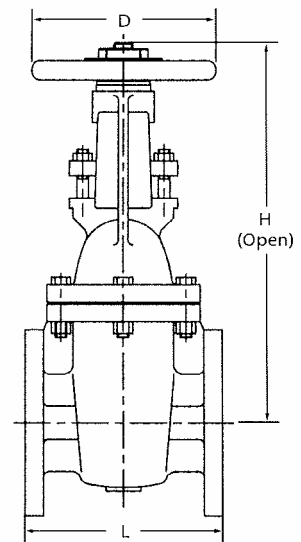

Note:

1. Other specifications and flange standards are available upon request.
2. Design and specifications are subject to change without prior notice.